

Precision - Linearpotentiometer DL30

standard version

The Precision - Linearpotentiometer DL30 is fit with an aluminium housing (30mm x 30mm) and a stainless steel pushrod to come up to industrial needs. Therefore the DL30 is a very precise motion potentiometer with a high resolution and the highest protection against environmental conditions.

The multiple noble metal slider tap and the noble metal wirewound resistor element ensures a reliable function.

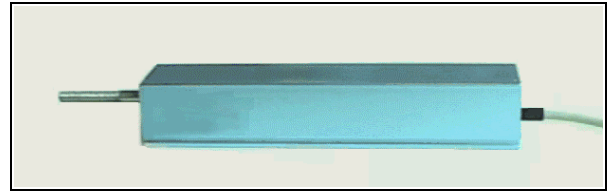

mechanical data

- 1.1 housing..... : aluminium
- 1.2 pushrod..... : stainless steel $\varnothing 6^{h8}$
- 1.3 bearing..... : permaglide sliding bearing
- 1.4 resistor element..... : noble metal winding
- 1.5 slider tap..... : noble metal, multiple
- 1.6 housing protection class..... : IP 60
- 1.7 connections..... : cable connection, 3 m
- 1.8 fixing element..... : clamping claws
- 1.9 functional path..... : 30...500 mm
- 1.10 motion speed..... : max. 1 m/sec
- 1.11 motion load life..... : 10×10^6 m travel

electrical data

- 2.1 resistance values, standard..... : 1, 2, 5, 10 K-Ohm
- 2.2 resistance values,max possible : according to table
- 2.3 resistance tolerance..... : $\pm 3\%$
- 2.4 lowest starting resistance..... : 0,05% of overall resistance
- 2.5 linearity tolerance..... : $\pm 0,3\%$
- 2.6 insulation resistance..... : 20 MOhm
- 2.7 test voltage..... : 500 V, 50 Hz
- 2.8 operating voltage..... : max. 50 V
- 2.9 power rating..... : max. 2 Watt
- 2.10 slider load current..... : max. 100 mA
- 2.11 temperature coefficient..... : 20 ppm/ $^{\circ}$ C
- 2.12 temperature range..... : -50° C till $+100^{\circ}$ C

options

- shorted segments
- taps
- different functional path
- resistance tolerance: $\pm 1\%$
- linearity: min. 0,1%
- pushrod: special length
- housing protection class IP65
- plug connection
- oil filling
- limit positioning switch

accessories

- adapter plate
- lengthened connection cable
- swivelhead
- plug

other types

- integral measuring transducer, 0/4 ... 20 mA oder 0 ... 10 VDC (housing length: $L1 = L1 + 50$)

- spring function: caliper design
- spring function: recuperating spring

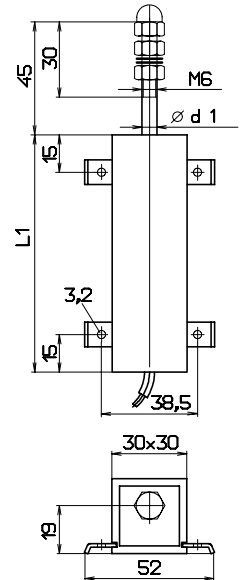

type list		standard		resistance total	order
type	way	L1	d1	max. K Ohm	#
DL30 / 30	30 mm	95 mm	$\varnothing 6$ mm	25	33000
DL30 / 50	50 mm	115 mm	$\varnothing 6$ mm	40	33005
DL30 / 100	100 mm	165 mm	$\varnothing 6$ mm	80	33010
DL30 / 150	150 mm	215 mm	$\varnothing 6$ mm	120	33015
DL30 / 200	200 mm	265 mm	$\varnothing 6$ mm	160	33020
DL30 / 250	250 mm	315 mm	$\varnothing 6$ mm	200	33025
DL30 / 500	500 mm	615 mm	$\varnothing 10$ mm	400	33035

fastening

standard

4 pcs. clamping claws
article #: 012.210302
(delivery includes)

option

adapter plate
article #: 332.090102
1 pc. till way 150 mm
2 pcs. from way 200 mm

Linearpotentiometer with ways longer than 500 mm will be built usually with integrated transducer.

Mounting possibilities with additional adapter plate (option: article#: 332.09 01 02)

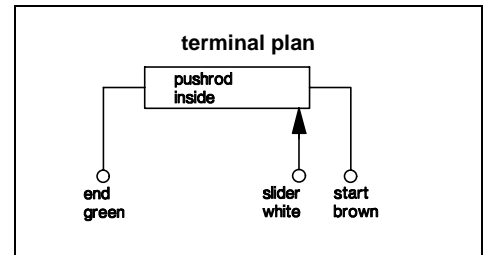
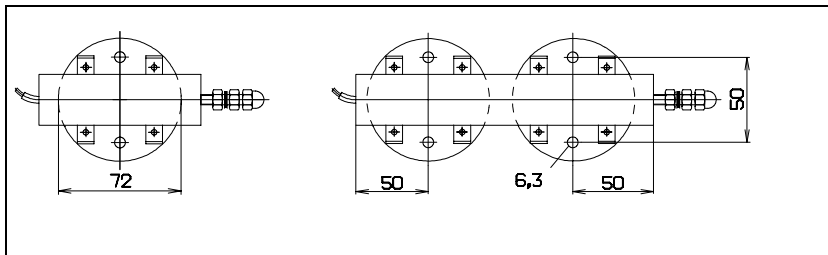

article #: 334.650110
sheet: KE3301.DOC
updated: 30.04.02
order #: see table
side: 33 - 01